

# For Sale

\$3.2 SF

## 9521 Railroad

El Paso, TX

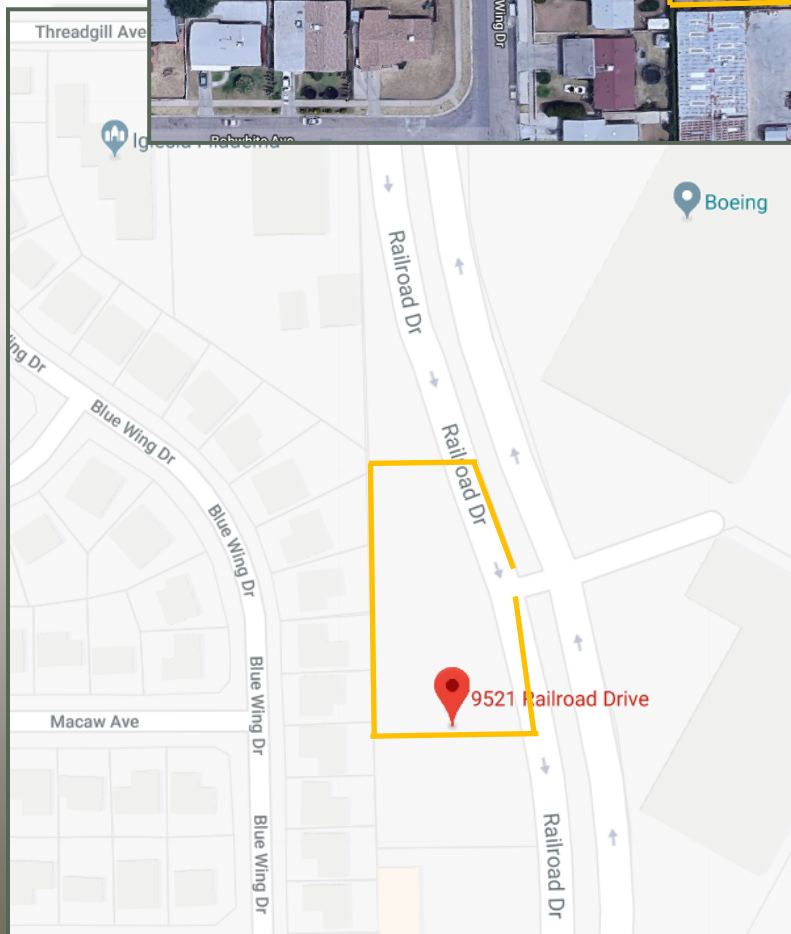

**Prime commercial vacant land located in Northeast El Paso, TX. Ideal for warehouse, storage, and open truck storage.**

**Size: 46,288 SF (1.06 ac)  
Zoning: M1**

**Roland H. Correa**  
915.328.9992 cell  
RC Properties  
roland@rcpropertieselp.com  
www.rcproperties-elp.com



Information deemed reliable, but should be verified.